

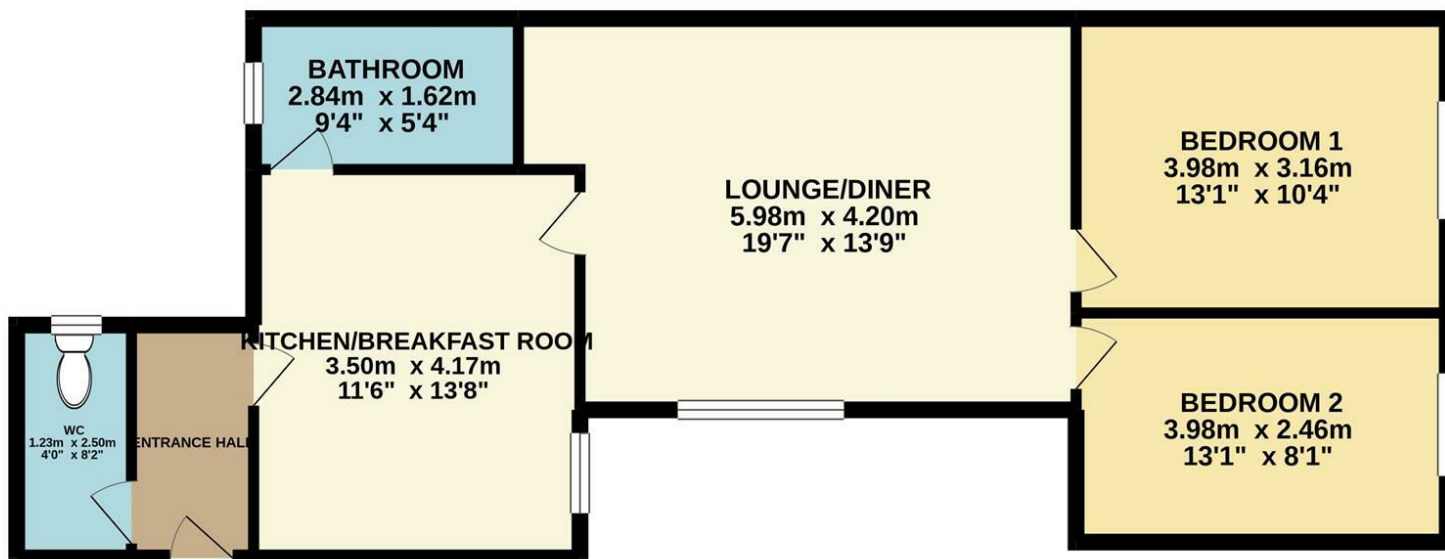

Trinity Street | Norwich | NR2
 Guide Price £180,000

abbotFox

GROUND FLOOR
 71.3 sq.m. (768 sq.ft.) approx.



TOTAL FLOOR AREA : 71.3 sq.m. (768 sq.ft.) approx.

Whilst every attempt has been made to ensure the accuracy of the floorplan contained here, measurements of doors, windows, rooms and any other items are approximate and no responsibility is taken for any error, omission or mis-statement. This plan is for illustrative purposes only and should be used as such by any prospective purchaser. The services, systems and appliances shown have not been tested and no guarantee as to their operability or efficiency can be given.
 Made with Metropix ©2021

Energy Efficiency Rating		
	Current	Potential
Very energy efficient - lower running costs		
(92 plus) A		
(81-91) B		
(69-80) C		
(55-68) D		
(39-54) E		
(21-38) F		
(1-20) G		
Not energy efficient - higher running costs		
England & Wales	EU Directive 2002/91/EC	

Disclaimer – In accordance with the Property Misdescriptions Act, the company gives notice that all descriptions, references to condition, necessary permissions for use and other details are given in good faith and believed to be correct, but any intending lessees do not rely on them as statements of fact, but must satisfy themselves by inspection or other means, as to their accuracy.



abbotFox presents this two bedroom first floor apartment. Located in the heart of the Golden Triangle, and offering a variety of amenities and the City Centre within walking distance, this is an ideal opportunity for first time buyer or buy-to-let investor. With accommodation comprising of an entrance hall, cloakroom, kitchen breakfast room, generous lounge and two double bedrooms, this property is deceptively spacious. With the property also offering allocated parking and access to communal gardens, an internal viewing comes highly recommended.

Guide price £180,000 - £190,000

